

Description

Top for poles made from ductile cast iron UNI EN 1563, S235J steel UNI EN 10219-1 hot-dip galvanized as per UNI EN ISO 1461 standards, matching the shape, size, and various decorations in the project drawing.

The top is made up as follows:

1°) A pastoral structure 88 cm high with a 68 cm projection. The frame is made of steel tubing (diam. 4.2 cm) with a cast iron connector (C), and a cast iron light fixture mount (E) with 3/4" GAS threading, fully hot-dip galvanized, and a steel tube (D - diam. 6 cm). The pastoral part should be inserted 28 cm into the pole core (A) and secured with six stainless steel M8 set screws (B). The connector (C) protects the joint from water infiltration. The power cable runs inside the arm.

The total height of the top is 88 cm.

Surface Protection

Refer to specific descriptions for the material painting processes.

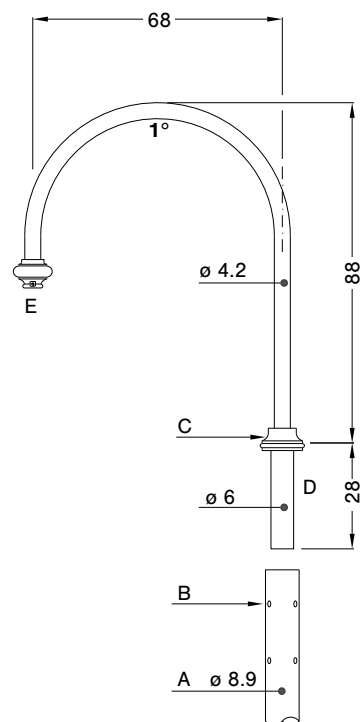

Exploded View